

Pacific Grove Unified School District Conceptual Planting Masterplans



Pacific Grove, California

Board Approved June 3, 2010

SCHOOL MAP:

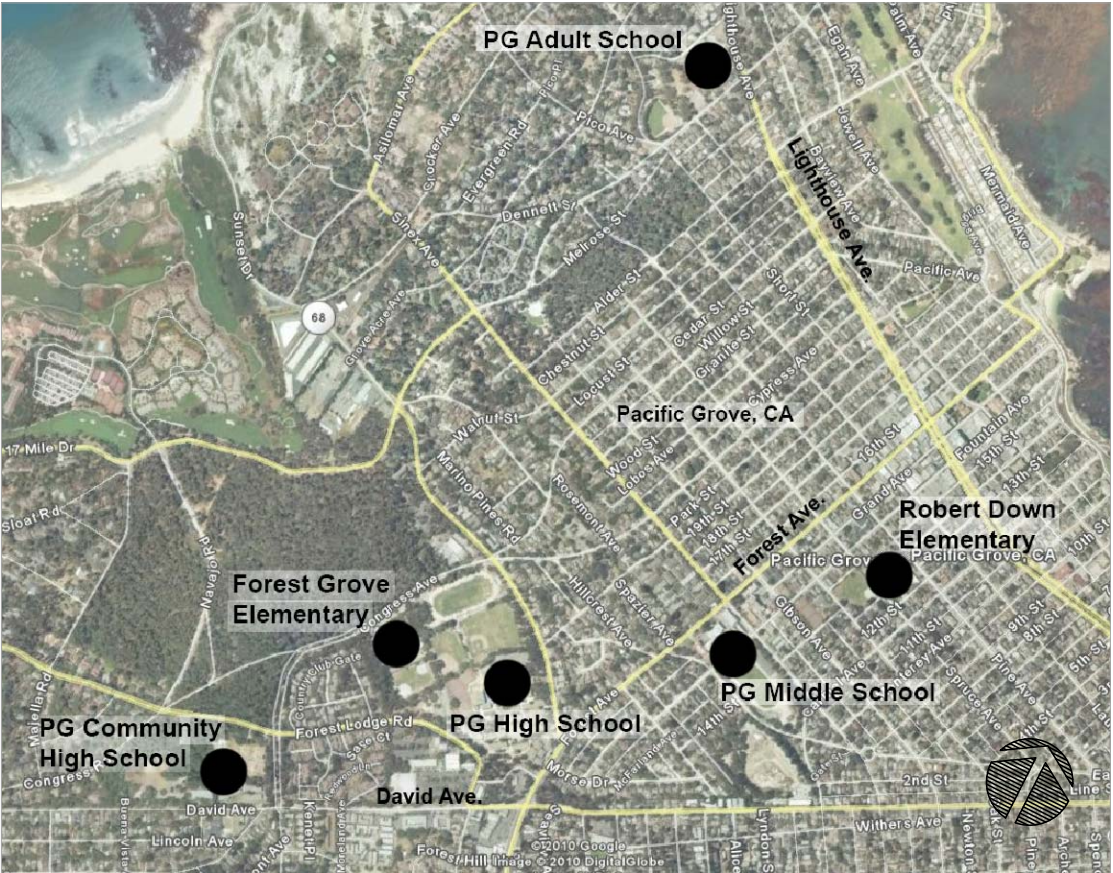

SHEET INDEX:

<u>PAGE NO:</u>	<u>CONTENTS:</u>
1	Cover Sheet
2	Introduction
3 - 4	Plant Zones
5 - 8	Plant Lists
9 - 10	Masterplan Legend and Planting Details
11 - 12	PG High School
13	PG Adult School
14	Forest Grove Elementary
15	Robert Down Elementary
16 - 17	PG Middle School
18	PG Community High School
19 - 21	Plant Palette



Pacific Grove Community High School



Pacific Grove High School



Forest Grove Elementary School



Pacific Grove Middle School

Introduction

The purpose of this document:

To provide Board approved direction for the maintenance and improvement of the landscaped areas of the district's properties through either district or non-district sponsored activities.

Principles:

1. As a major owner of publicly owned and landscaped land in Pacific Grove, it is important and appropriate for the district to identify how it will maintain and improve its properties to insure that they are properly retained for future generations.
2. As a potential major user of limited regional water resources for landscaping purposes, it is important and appropriate that the district plans to maintain and improve its landscaped areas in a way that minimizes such water usage.
3. As an educational organization that tries to focus as much of its limited financial resources on the instructional program as possible, it is important and appropriate that the district develop plans to ensure that the expense of the ongoing maintenance and improvement of landscape areas, and the associated liability exposure, be minimized.
4. As one of the largest operators of landscaped spaces in the area, it is appropriate for the district to plan to attempt to assist in the maintenance of native vegetation when appropriate and not knowingly participate in the introduction or maintenance of invasive plants that are threatening the native vegetation of the region.
5. The maintenance and improvement of the district's landscaped properties should be planned for in a way that contributes to the educational program of the district, creates an attractive environment, and is designed and implemented in a manner that minimizes the budgetary commitment necessary to address ongoing maintenance and liability issues.

Planting Zones

- A1 Lawn Areas**
- A2 Ornamental Tree planting areas**
- A3 Ornamental shrubs/groundcover planting areas**
- B1 Oak – Pine planting area**
- B2 Open space grass/lawn area**
- B3 Native grass restoration area**
- C1 Erosion control seed area**
- D1 Potted and portable planting area**

A1 Lawn Areas

Maintenance: Medium to high.

These areas require detailed inspections and services once a week. Grass is required to be cut and weed free year round. Maintain rodent control.

Irrigation: Yes.

Lawn seed or sod shall be a turf type, tall fescue. No grass (and spray irrigation) shall surround existing or new trees within 3 feet. Oak trunks shall not have any irrigation water touching them. Limited tree planting shall be allowed in lawn areas, but not in sports field lawn areas. See A2 Ornamental Tree list.

Where possible, the non-essential lawn areas (i.e. not needed for sports or play fields, or student gathering areas) should be transitioned to Zone A3 to reduce both water and maintenance needs.



A1 Lawn Area: Robert Down Elementary

A2 Ornamental tree planting area

Maintenance: Low to medium.

These areas require minimal maintenance services a few times a year, including trimming and pruning. Tree areas are to be weed and debris free year round.

Irrigation: Yes.

Trees shall be setback from walkways, structures, other trees, etc. at minimal distances shown on the Plant List.

A3 Ornamental shrubs/groundcover planting area

Maintenance: Low to medium.

These areas require minimal maintenance services a few times a month, including trimming and pruning. Planting areas are to be weed and debris free year round.

Irrigation: Yes.

Plants shall be setback from walkways, structures, other plants, etc. at minimal distances shown on the Plant List.



A3 Ornamental shrub planting area: PG Middle School

B1 Oak - Pine planting area

Maintenance: Very low.

These areas may require minimal maintenance services and inspections a few times a year, including trimming and pruning. New plantings may require protective measures from deer.

Irrigation: Temporary drip to new plantings only, or scheduled hand watering.

New plantings shall allow for optimum growth and minimal impact on existing vegetation. Plants shall be setback from walkways, structures, other plants, etc. at minimal distances shown on the Plant List.

B2 Open space grass/lawn area

Maintenance: Very low.

These areas may require minimal maintenance services and inspections a few times a year, including mowing and rodent control.

Irrigation: None.

Open space grass/lawn areas are existing grass open spaces, recommended to be maintained as clear open space, no trees.



B2 Open space grass/lawn area: PG Adult School

B3 Native grass restoration area

Maintenance: Very low.

These areas may require minimal maintenance services and inspections a few times a year, including mowing and weeding.

Irrigation: None.

C1 Erosion control seed area

Maintenance: Very low.

These areas may require minimal maintenance services and inspections a few times a year, including mowing and weeding.

Irrigation: None.

D1 Potted and portable planting area

Maintenance: Low to medium

Additional areas may be used for this purpose, as long as maintenance and access issues are addressed.

Irrigation: None, but hand watering may be allowed.

Exotic Plant Species Removal

Several species of invasive exotic plants already inhabit the school campuses; Pampas Grass (*Cortaderia jubata*), French Broom (*Genista monspessulana*), and Ice Plant (*Carpobrotus edulis*).

Pampas Grass and French Broom shall be regarded as highly invasive and a hazard to the campuses and local community. They should be targeted for removal whenever possible. Pampas grass has the ability to multiply fast, by scattering seeds, and taking over the landscape. French Broom is also very invasive, and becomes a dry summer fire hazard. These plants shall be eradicated by spraying and pulling by qualified personnel.

Ice plant shall also be removed whenever possible. However, ice plant located on slopes greater than 5% shall only be removed when an approved replacement plant will take its place, to help with erosion control.



	PGUSD PLANT LIST:						
	Notes: CA Native: native habitat includes California, not only endemic to California. All plants shall be considered low water use, unless otherwise noted. Irrigated = recommended in irrigated areas only. Dry ok = can be in lawn and in dryer zones.						
	ZONE	BOTANICAL NAME	SUGGESTED VARIETIES	COMMON NAME	CA NATIVE	SPACING	NOTES
	A2 ORNAMENTAL TREES						
		<i>Geijera parviflora</i>		Australian Willow		15'	Dry ok
		<i>Liquidambar styraciflua</i>	Palo Alto	Sweet Gum		10-15'	Irrigated
		<i>Lyonothamnus floribundus</i>		Catalina Ironwood	X	15-20'	Dry ok
		<i>Magnolia grandiflora</i>		Evergreen Magnolia		25'	Irrigated
		<i>Magnolia soulangiana</i>		Saucer Magnolia		20'	Irrigated
		<i>Magnolia stellata</i>		Star Magnolia		10-15'	Irrigated
		<i>Melaleuca quinquenervia</i>		Cajeput Tree		15'	Irrigated
		<i>Metrosideros excelsus</i>		New Zealand Christmas Tree		10-12'	Dry ok
		<i>Olea europea</i>	Swan Hill	Fruitless Olive		15'	Dry ok
		<i>Pistacia chinensis</i>		Chinese Pistache		15-20'	Irrigated
		<i>Prunus c. 'Thundercloud'</i>		Flowering Plum		15'	Irrigated
		<i>Pyrus calleryana</i>	Chanticleer	Callery Pear		15'	Irrigated
		<i>Sequoia sempervirens</i>	Aptos Blue	Coast Redwood	X	10-15'	Irrigated
		<i>Ulmus parvifolia</i>		Chinese Elm		20'	Irrigated
	A3 ORNAMENTAL SHRUBS AND GROUNDCOVERS						
	Large Shrubs	<i>Arctostaphylos 'Dr. Hurd'</i>		Dr. Hurd Manzanita	X	8-12'	
		<i>Calycanthus occidentalis</i>		Spice Bush	X	8-12'	Moist areas ok
		<i>Camellia japonica</i>	Alba Plena, Adolphe Audusson	Camellia		6-8'	Irrigated
		<i>Cotinus coggygria</i>		Smoke Tree		8-10'	
		<i>Dendromecon harfordii</i>		Island Bush Poppy	X	8-12'	
		<i>Fremontodendron californicum</i>	Ken Taylor, San Gabriel, Pacific Sunset	Ken Taylor Flannelbush	X	8-12'	
		<i>Lavatera assurgentiflora</i>		Tree Mallow	X	8-12'	
		<i>Lavatera maritima (Lavatera bicolor)</i>		Tree Mallow		8-12'	
		<i>Leonotis leonurus</i>		Lion's Tail		8-12'	
		<i>Leucadendron hybrid 'Safari Sunset'</i>		Safari Sunset Conebush		8-12'	
	Small to Medium Shrubs	<i>Agapanthus sp.</i>	Flore Pleno, New Blue, White	Lily-of-the-Nile		2-4'	
		<i>Arctostaphylos spp.</i>		Manzanita	X	6-8'	
		<i>Artemisia absinthium 'Powis Castle'</i>		Common Wormwood		4-6'	
		<i>Callistemon viminalis 'Little John'</i>		Dwarf Bottlebrush		6-8'	
		<i>Ceanothus 'Joyce Coulter'</i>		Creeping Mountain Lilac	X	6-8'	
		<i>Cistus spp.</i>		Rockrose		4-6'	
		<i>Convolvus cneorum</i>		Bush Morning Glory		3-4'	
		<i>Correa 'Ivory Bells'</i>		White Australian Fuchsia		4'	
		<i>Dietes bicolor</i>		Evergreen Iris		4'	
		<i>Dietes vegata</i>		Butterfly Iris		3-4'	
		<i>Eriogonum grande var rubescens</i>		Red-Flowered Buckwheat	X	3-4'	
		<i>Gaura lindheimeri</i>		Butterfly Gaura		3-4'	
		<i>Grevillea rosmarinifolia</i>	Scarlet Sprite	Rosemary Grevillea		4-6'	
		<i>Hemerocalis hybrids</i>	Big Gold, Orange Crush, Rojo Alto	Big Gold Daylily		3'	

	ZONE	BOTANICAL NAME	SUGGESTED VARIETIES	COMMON NAME	CA NATIVE	SPACING	NOTES
	A3 Continued	<i>Kniphofia uvaria</i>	Christmas Cheer, Shining Scepter	Red Hot Poker		2'	
		<i>Lavandula angustifolia</i>	Alba	English Lavender		4'	
		<i>Limonium perezii</i>		Sea Lavender		3'	
		<i>Phormium 'Amazing Red'</i>		Amazing Red New Zealand Flax		4'	
		<i>Phormium 'Cream Delight'</i>		Cream Delight New Zealand Flax		4'	
		<i>Phormium 'Gold Sword'</i>		Gold Sword New Zealand Flax		4'	
		<i>Polygala fruticosa 'Petite Butterfly'</i>		Dwarf Sweet Pea Shrub		4'	
		<i>Polygala myrtifolia 'Grandifolora'</i>		Sweet Pea Shrub		4'	
		<i>Raphiolepis spp.</i>		Indian Hawthorn		4'	
		<i>Rosa californica</i>		California Wild Rose	X	6'	In perimer areas, away from pedestrians
		<i>Rosmarinus officinalis 'Benenden Blue'</i>		Rosemary		4-6'	Can attract bees
		<i>Salvia clevelandii 'Allen Chickering'</i>		Cleveland Sage	X	4-6'	
		<i>Salvia greggii (various colors)</i>		Autumn Sage		3-4'	
		<i>Salvia leucantha</i>	Santa Barbara	Mexican Sage		4'	
		<i>Salvia leucophylla</i>		Purple Sage	X	4'	
		<i>Sollya heterophylla</i>	Monterey Bay Sapphire	Bluebell Creeper		3-4'	
	Groundcovers	<i>Achillea millefolium</i>	Moonshine, colors available	Common Yarrow	X	6" O.C.	
		<i>Arctostaphylos spp.</i>		Manzanita	X	6-8'	
		<i>Armeria maritima</i>	Alba	Sea Thrift	X	18"	4" pots
		<i>Asteriscus maritimus</i>	Gold Coin, Compact Gold Coin	Beach Daisy		3'	
		<i>Baccharis pilularis 'Twin Peaks'</i>		Dwarf Coyote Bush	X	18"	from flats
		<i>Ceanothus gloriosus 'Point Reyes'</i>		Point Reyes Ceanothus	X	6-8'	
		<i>Ceanothus griseus horizontalis</i>	Yankee Point	Carmel Mountain Lilac	X	8-10'	
		<i>Cerastium tomentosum</i>		Snow in Summer		18"	
		<i>Cistus salvifolius</i>		Sageleaf Rockrose		4'	
		<i>Convolvulus mauritanicus</i>		Ground Morning Glory		3'	
		<i>Coreopsis maritima</i>		Sea Dahlia	X	2'	
		<i>Coreopsis verticilla</i>		Beach Coreopsis		2'	
		<i>Correa 'Dusky Bells'</i>		Dusky Bells Australian Fuchsia		3'	
		<i>Erigeron glaucus</i>	Arthur Menzies	Seaside Daisy	X	1-2'	
		<i>Fragaria vesca</i>		Wood Strawberry	X	1-2'	
		<i>Gazania spp.</i>		Gazania		12"	from flats
		<i>Geranium 'Johnsons Blue'</i>		Johson's Blue Geranium		2-3'	
		<i>Grevillea lanigera 'Coastal Gem'</i>		Coastal Gem Grevillea		3'	
		<i>Heuchera maxima</i>		Island Alum Root	X	2-3'	
		<i>Lantana spp.</i>		Lantana		4-6'	
		<i>Penstemon spp.</i>		Penstemon	X	2-3'	
		<i>Phormium tenax spp.</i>		Flax		3-4'	
		<i>Rhamnus californica 'Seaview'</i>		Seaview Coffeeberry	X	4'	
		<i>Sisyrinchium bellum</i>		Blue-eyed Grass	X	1-2'	
		<i>Stachys byzantina</i>		Lamb's Ears		2'	
		<i>Symphoricarpos mollis</i>		Creeping Snowberry	X	3'	
		<i>Teucrium chamaedrys</i>		Germander		2-3'	
		<i>Verbena x hybrida 'Dark Purple'</i>	Homestead Purple, Tapien Lavender	Dark Purple Verbena		2-3'	
		<i>Verbena x hybrida 'White'</i>	Babylon White, Tukana White	White Verbena		2-3'	

	ZONE	BOTANICAL NAME	SUGGESTED VARIETIES	COMMON NAME	CA NATIVE	SPACING	NOTES
	A3 Continued Vines	<i>Bougainvillea 'Barbara Karst'</i>		Barbara Karst Bougainvillea		5'	Away from pedestrians
		<i>Bougainvillea spectabilis</i>		Bougainvillea		5'	Away from pedestrians
		<i>Distictus buccinatorius</i>		Bloodred Trumpet Vine		5'	
		<i>Ficus pumila</i>		Creeping Fig		5'	
		<i>Hardenbergia comptoniana</i>		Lilac Vine		5'	
		<i>Rosa banksiae 'Lutea'</i>		Lady Bank's Yellow Rose		10'	In perimeter areas, away from pedestrians
		<i>Rosa banksiae var banksiae</i>		White Banksia		10'	In perimeter areas, away from pedestrians
		<i>Trachelospermum jasminoides</i>		Star Jasmine		5'	
	B1 OAK - PINE PLANTING						
	Trees	<i>Aesculus californica</i>		California Buckeye	X	25'	planted at edge of oak-pine forest
		<i>Pinus radiata</i>		Monterey Pine	X	20-25'	pitch-canker resistant
		<i>Quercus agrifolia</i>		Coast Live Oak	X	25-30'	
		<i>Umbellularia californica</i>		California Laurel	X	25'	
	Shrubs and	<i>Carpentaria californica</i>		Tree Anemone	X	8-12'	
	Groundcovers	<i>Ceanothus thyrsiflorus</i>	Snow Flurry, Sky Lark	Blue Blossom	X	8-12'	
		<i>Garrya elliptica</i>		Coast Silk Tassel	X	8-12'	
		<i>Heteromeles arbutifolia</i>		Toyon	X	8-12'	
		<i>Iris douglasiana</i>		Douglas Iris	X	12"	
		<i>Lupinus chamissonis</i>		Silver Dune Lupine	X	4'	
		<i>Mimulus aurantiacus (Diplacus latifolius)</i>	colors available	Sticky Monkey Flower	X	4'	
		<i>Rhamnus californica</i>	Eve Case, Mound San Bruno	Eve Case Coffeeberry	X	8-12'	
		<i>Ribes sanguineum</i>		Red Flowering Currant	X	4'	
		<i>Ribes speciosum</i>		Fuchsia Flowering Gooseberry	X	4'	
		<i>Romneya coulteri</i>		Matilija Poppy	X	8-12'	
		<i>Vaccinium ovatum</i>		Evergreen Huckleberry	X	3'	
		<i>Zauschneria californica</i>		California Fuschia	X	18"	
	B3 NATIVE GRASS RESTORATION						
		<i>Carex divulsa</i>		Berkeley Sedge	X		Moist areas, non irrigated
		<i>Carex tumulicola</i>		Foothill Sedge	X		Moist areas, non irrigated
		<i>Deschampsia caespitosa</i>		Tufted Hairgrass	X		Damp areas ok, non irrigated
		<i>Festuca californica</i>		California Fescue	X		Dry areas, non, or infrequent irrigation
		<i>Festuca glauca</i>	Elijah Blue	Blue Fescue			Dry areas, non, or infrequent irrigation
		<i>Festuca idahoensis</i>	Siskiyou Blue	Idaho Fescue	X		Dry areas, non, or infrequent irrigation
		<i>Festuca rubra</i>		Red Fescue	X		Dry areas, non, or infrequent irrigation
		<i>Helictotrichon sempervirens</i>		Blue Oat Grass			Dry areas, non, or infrequent irrigation
		<i>Juncus balticus</i>		Wire Rush	X		Moist areas, non irrigated
		<i>Juncus effusus</i>		Bog Rush	X		Moist areas, non irrigated
		<i>Juncus patens</i>		Spreading Rush	X		Moist areas, non irrigated
		<i>Muhlenbergia rigens</i>		Deer Grass	X		Dry areas, non irrigated
		<i>Nassella pulchra</i>		Purple Needlegrass	X		Dry areas, non irrigated

	ZONE	BOTANICAL NAME	SUGGESTED VARIETIES	COMMON NAME	CA NATIVE	SPACING	NOTES
	C1 EROSION CONTROL SEED						
		<i>Bromus carinatus</i>		California Brome	X		Dry or moist areas, non, or infrequent irrigation
		<i>Deschampsia caespitosa</i>		Tufted Hairgrass	X		non irrigated areas
		<i>Elymus glaucus</i>		Blue Wildrye	X		Dry or moist areas, non, or infrequent irrigation
		<i>Eschscholzia californica</i>		California Poppy	X		non irrigated areas
		<i>Festuca idahoensis</i>	Siskiyou Blue	Idaho Fescue	X		non irrigated areas
		<i>Festuca rubra</i>		Red Fescue	X		Dry or moist areas, non, or infrequent irrigation
		<i>Lupinus nanus</i>		Sky Lupine	X		non irrigated areas
		<i>Muhlenbergia rigens</i>		Deer Grass	X		non irrigated areas
		<i>Nassella pulchra</i>		Purple Needlegrass	X		Dry or moist areas, non, or infrequent irrigation
		<i>Sisyrinchium bellum</i>		Blue-eyed Grass	X		non irrigated areas

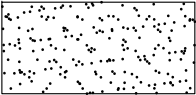
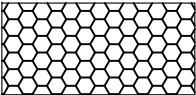
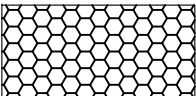
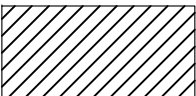
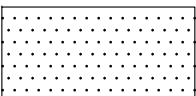
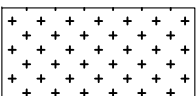
LEGEND

	A1 Lawn area
	A2 Ornamental tree planting area
	A3 Ornamental shrubs/groundcover planting area
	B1 Oak-Pine planting area
	B2 Open space grass/lawn area
	B3 Native grass restoration
	C1 Erosion control seed area
	D1 Potted and portable planting area

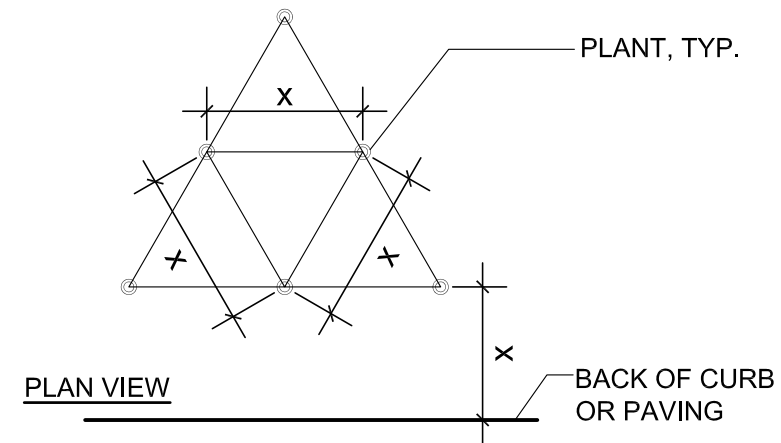

NOTE: FOR PLANT SPACING 'X', SEE PLANTING PLAN LIST

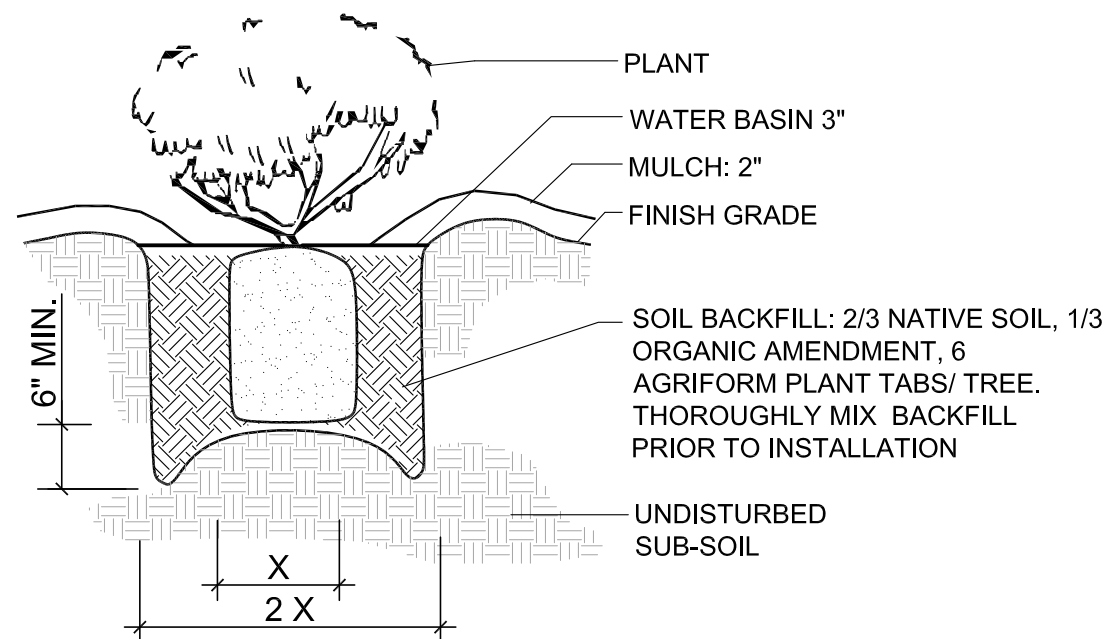

2

Shrub Planting

NTS

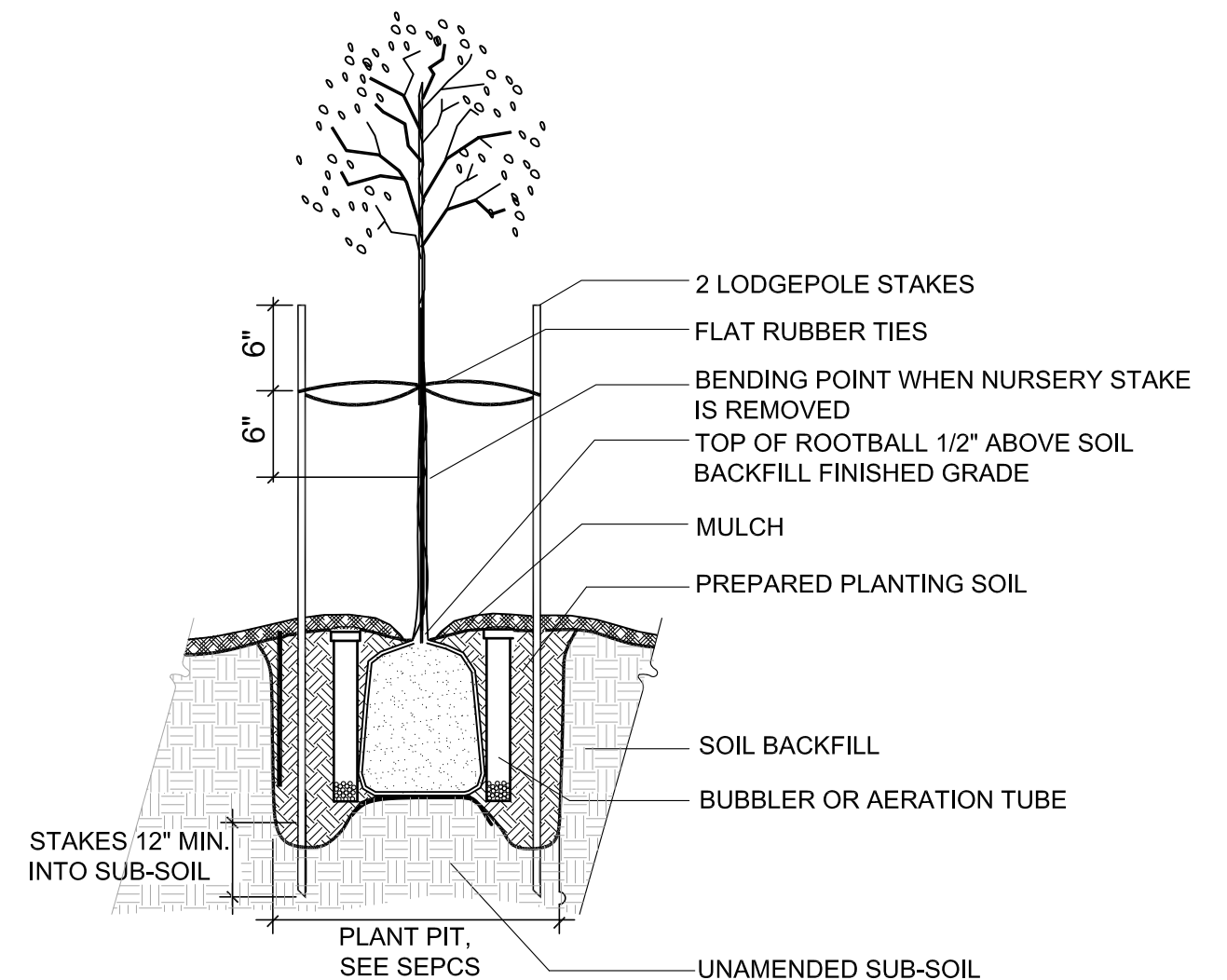
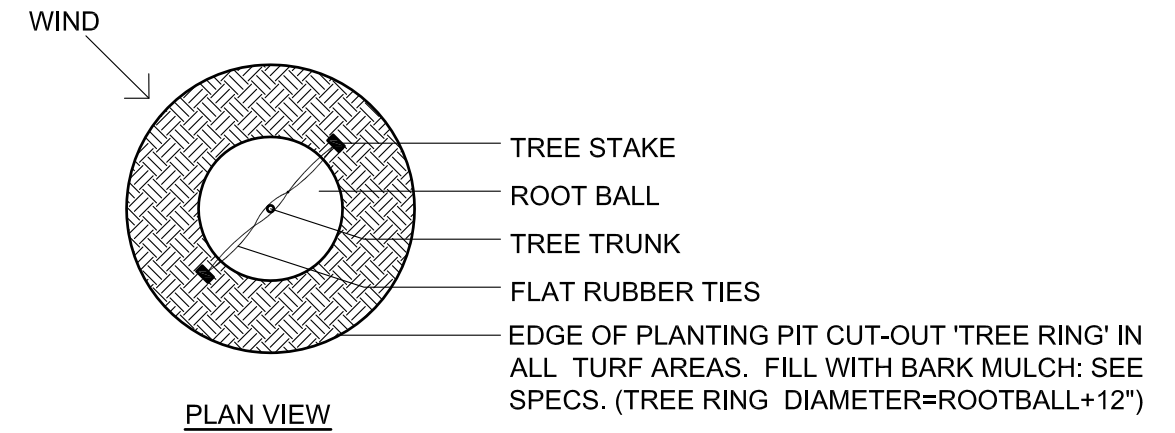

1

Tree Planting & Staking

NTS

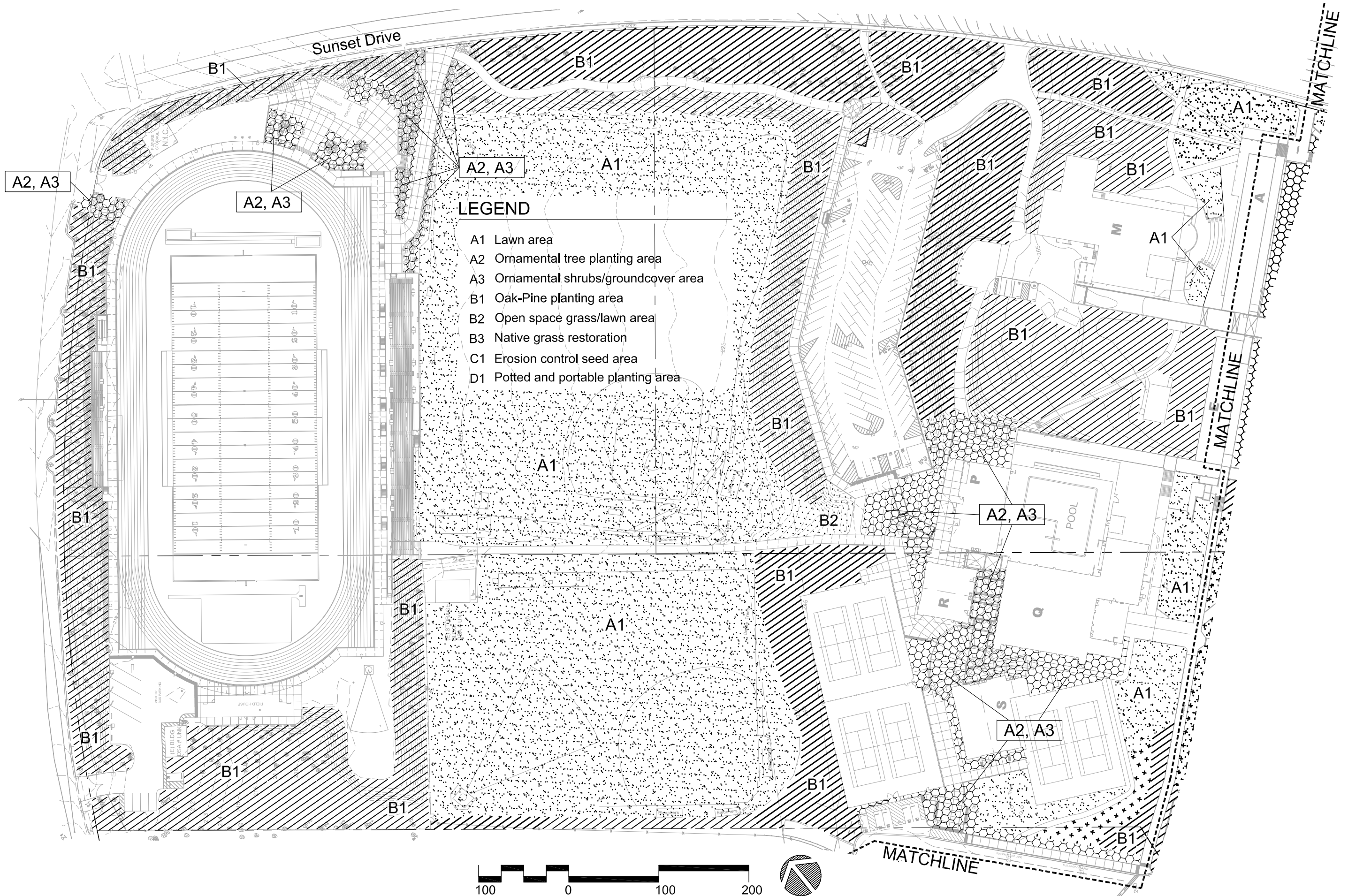

LEGEND

- A1 Lawn area
- A2 Ornamental tree planting area
- A3 Ornamental shrubs/groundcover planting area
- B1 Oak-Pine planting area
- B2 Open space grass/lawn area
- B3 Native grass restoration
- C1 Erosion control seed area
- D1 Potted and portable planting area

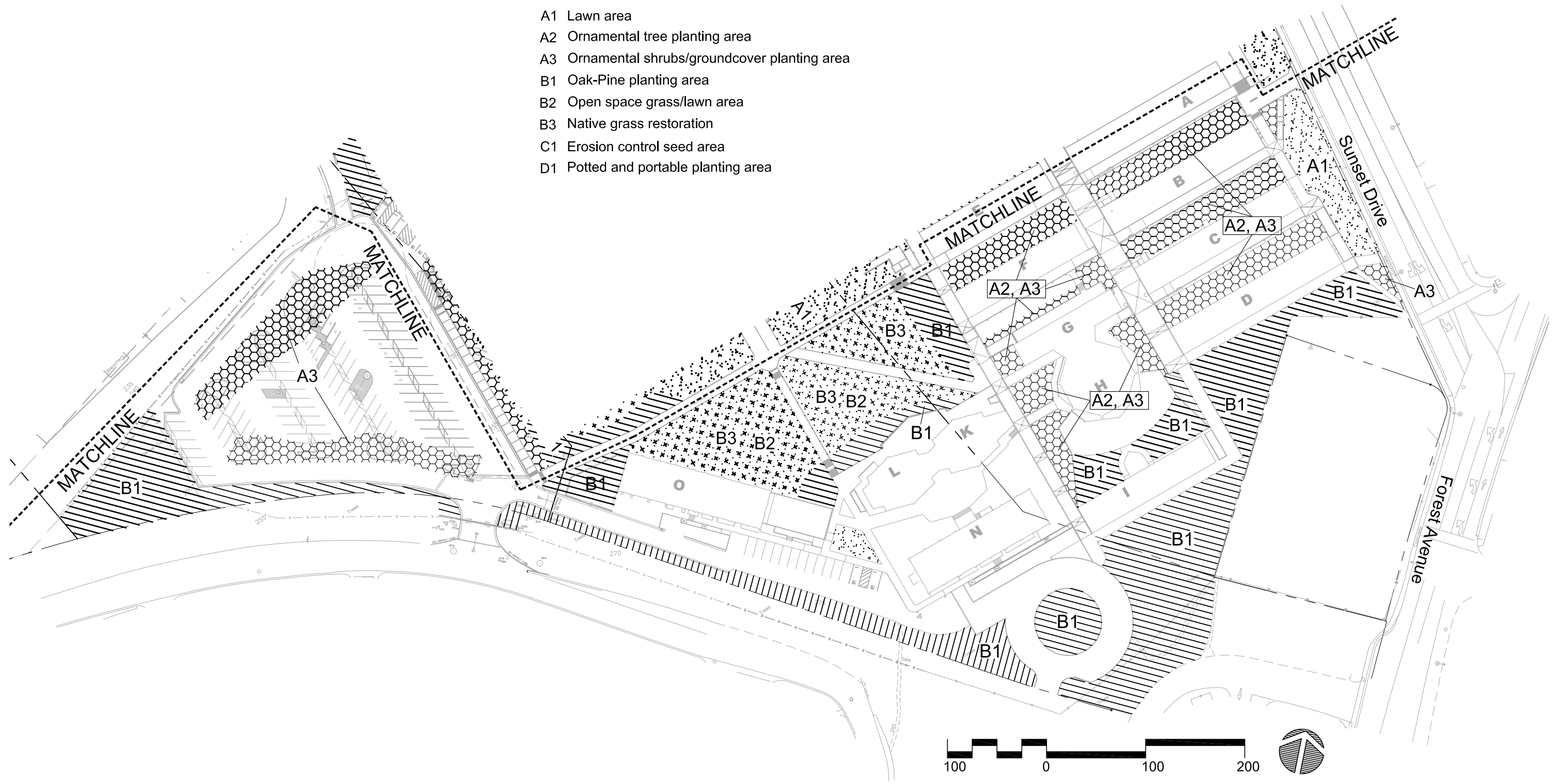

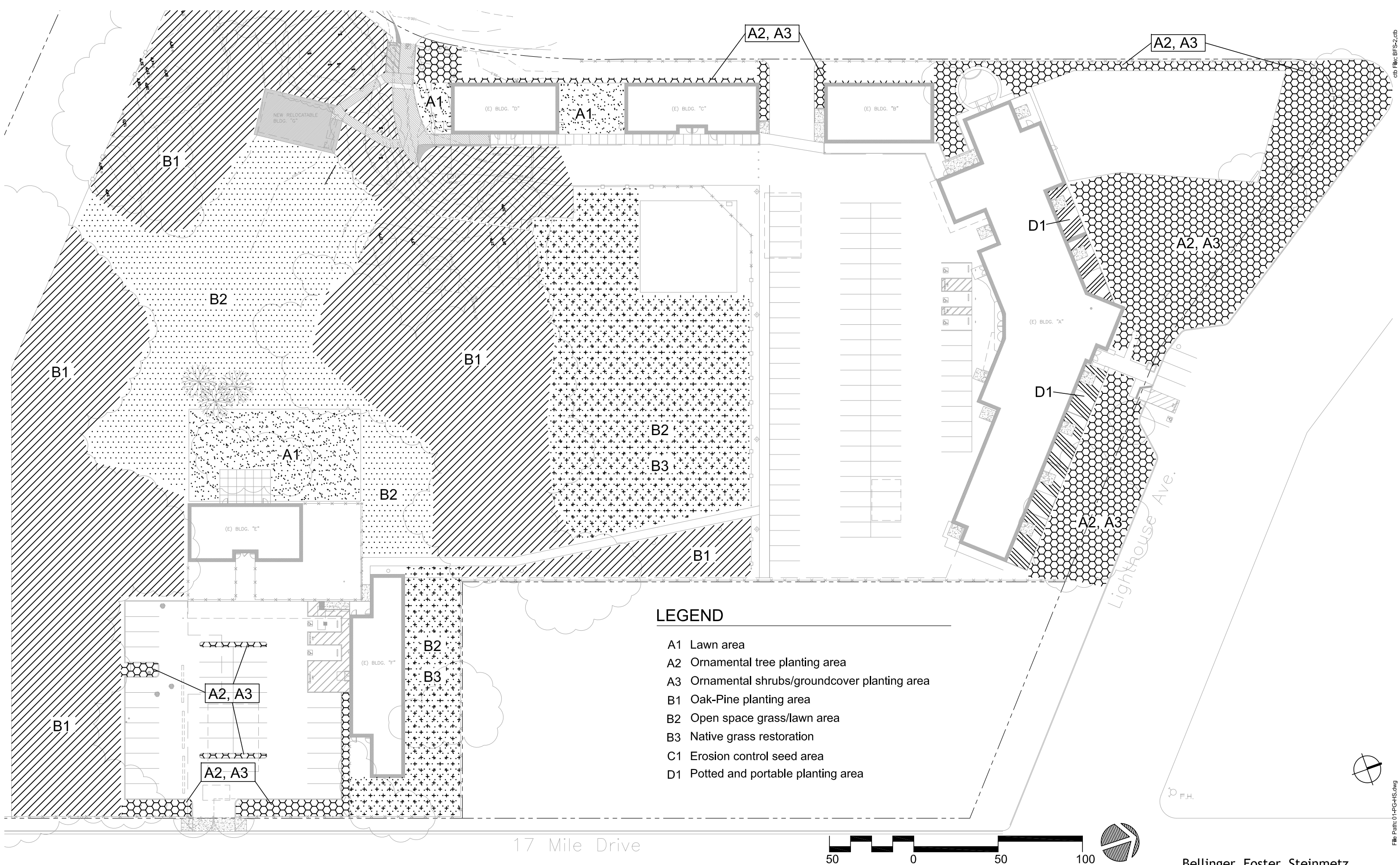

LEGEND

- A1 Lawn area
- A2 Ornamental tree planting area
- A3 Ornamental shrubs/groundcover planting area
- B1 Oak-Pine planting area
- B2 Open space grass/lawn area
- B3 Native grass restoration
- C1 Erosion control seed area
- D1 Potted and portable area



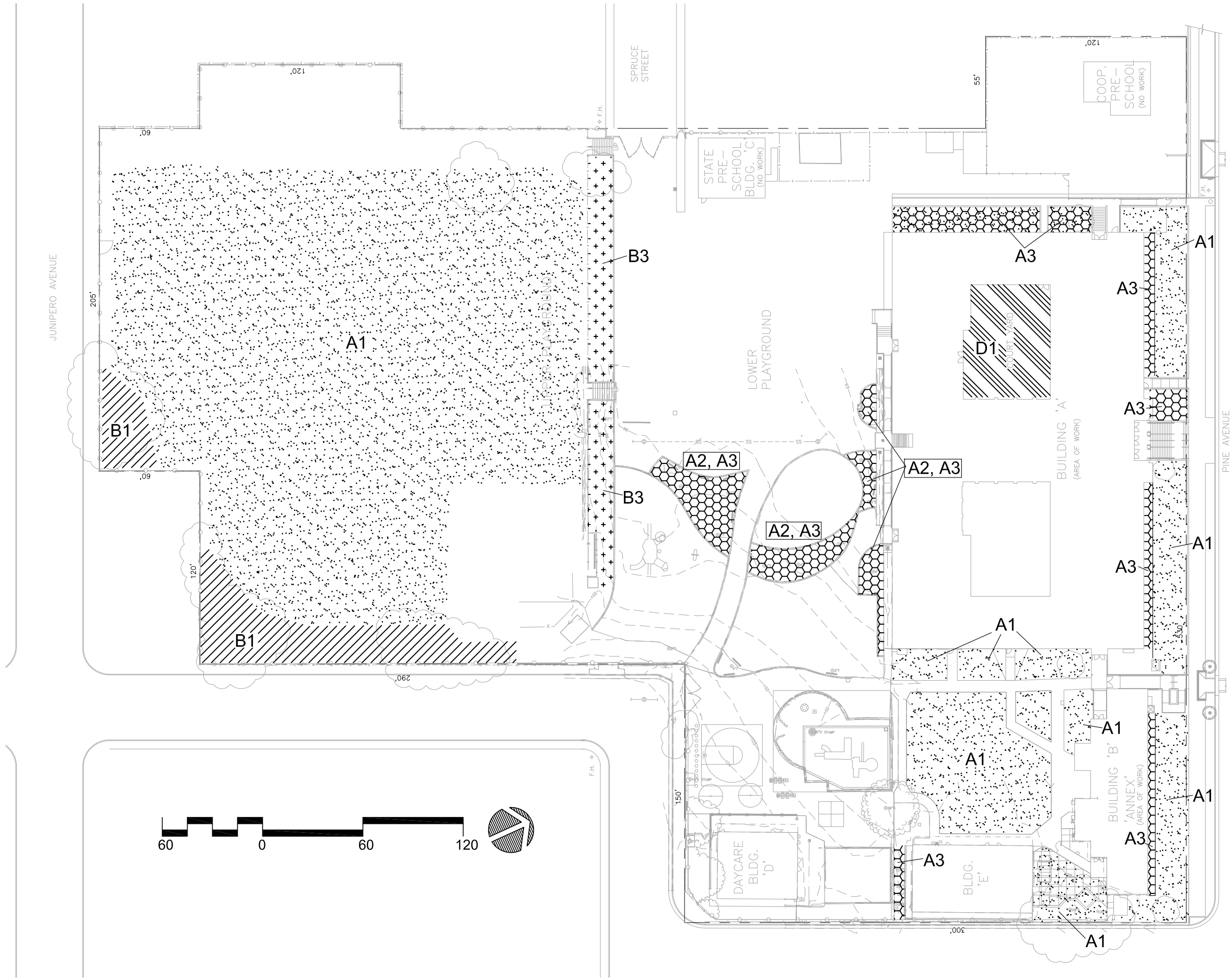

LEGEND

- A1 Lawn area
- A2 Ornamental tree planting area
- A3 Ornamental shrubs/groundcover planting area
- B1 Oak-Pine planting area
- B2 Open space grass/lawn area
- B3 Native grass restoration
- C1 Erosion control seed area
- D1 Potted and portable planting area

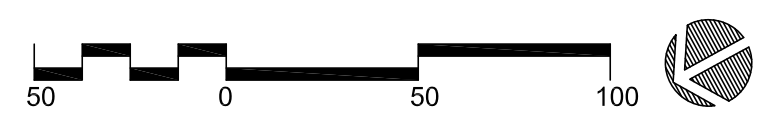
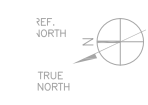
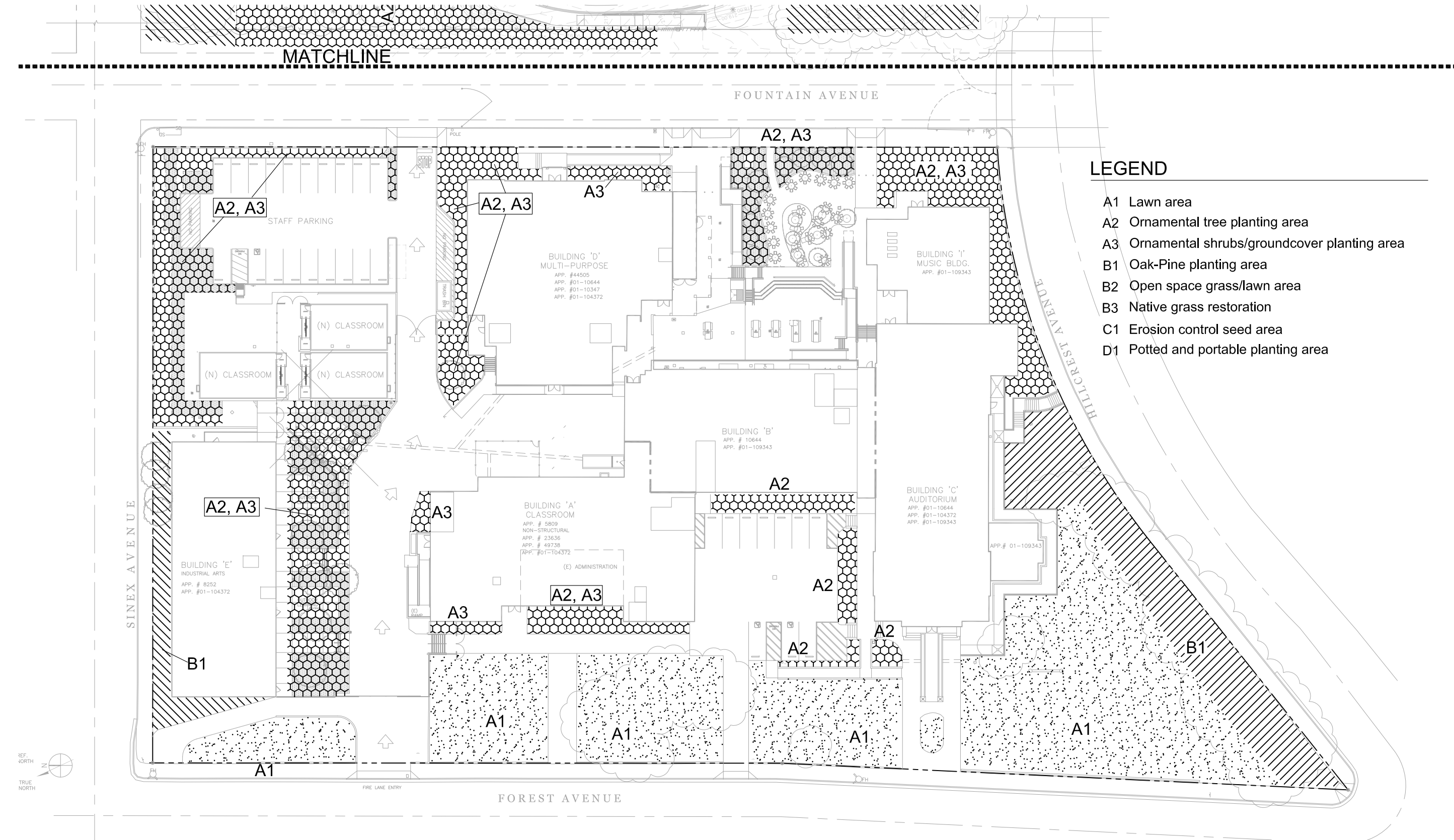

MATCHLINE

CARMEL AVENUE

HILLCREST AVENUE

LEGEND

- A1 Lawn area
- A2 Ornamental tree planting area
- A3 Ornamental shrubs/groundcover planting area
- B1 Oak-Pine planting area
- B2 Open space grass/lawn area
- B3 Native grass restoration
- C1 Erosion control seed area
- D1 Potted and portable planting area



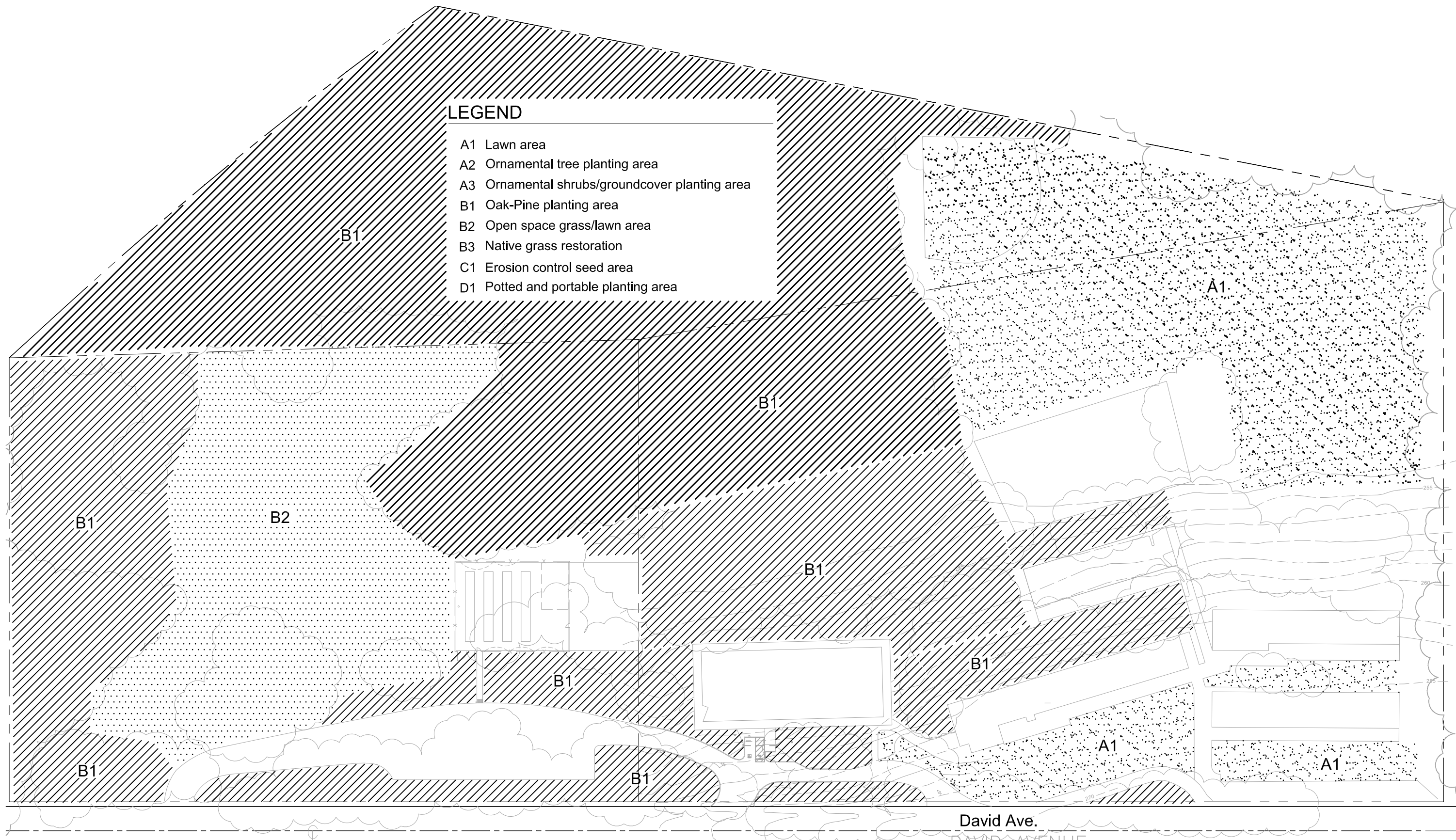

A2 - ORNAMENTAL TREES



Geijera parviflora



Liquidambar styraciflua



Lyonothamnus flofibundus



Magnolia grandiflora



Magnolia soulangiana



Magnolia stellata



Melaleuca quinquenervia



Metrosideros excelsus



Olea europea



Pistacia chinensis



Pyrus calleryana



Sequoia sempervirens



Ulmus parvifolia

A3 - ORNAMENTAL SHRUBS



Arctostaphylos spp.



Artemisia 'Powis Castle'



Callistemon v. 'Little John'



Cistus spp.



Convolvulus cneorum



Diets vegeta



Eriogonum grande v. rubescens



Fremontodendron californicum



Grevillea rosmarinifolia



Lavandula angustifolia



Phormium 'Amazing Red'



Phormium 'Cream Delight'

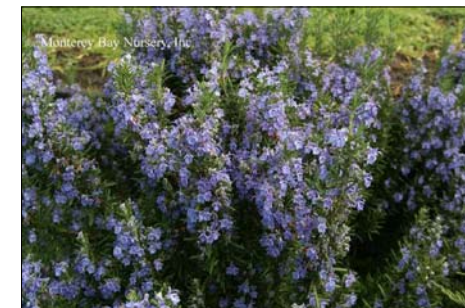

Rosmarinus officianalis



Salvia leucantha

A3 - ORNAMENTAL GROUNDCOVER



Achillea millefolium



Arctostaphylos spp.



Armeria maritima



Asteriscus maritimus



Ceanothus g. horizontalis



Cistus salvifolius



Coreopsis verticilla



Correa 'Dusky Bells'



Erigeron glaucus



Gazania spp.



Penstemon humilis



Sisyrinchium bellum



Stachys byzantia



Verbena 'Dark Purple'

A3 - ORNAMENTAL VINES



Hardenbergia comptoniana



Bougainvillea 'Barbara Karst'



Rosa banksiae 'Lutea'



Distictus buccinatorius



Rosa banksiae var. banksiae

B1 - OAK PINE
PLANTING



Aesculus californica



Ceanothus thyrsiflorus



Garrya elliptica



Heteromeles arbutifolia



Quercus agrifolia



Rhamnus californica



Romneya coulteri



Umbellularia californica

B3 - NATIVE
GRASSES



Carex divulsa



Deschampsia caespitosa



Festuca glauca



Festuca idahoensis



Helictotrichon sempervirens



Juncus patens



Muhlenbergia rigens